

BRIMSON ZONE

Pit Name	Legal	Price/cy	Notify Public Works of Permit/ District		Locked, Key Needed	Comments/Special Conditions
			Y			
Laine Road 532-12L	NE-SW 12-53-12	\$3.50	Y	5	Y	Sand and fine gravel, silty in spots. Rock for sale or use.
Ross Creek 523-04C	NE-NW 4-52-13	\$3.50	Y	5	Y	Gravel, small cobble. Two class-5 stockpiles on site: Public Works - Land Dept and Normanna Township. Avoid seep area on southeast bank.
Rossini Rd. (95) 542-21G	SW-NE 21-54-12	\$3.50	Y	5	Y	Clean sand, gravel, small cobble. Public Works stockpiles. Screened rock.
South Rd (aka Number 4) 555-01RS	SE-SE 1-55-15	\$3.50	Y	6	Y	Long term multipurpose pit. Next expansion expected to be east of the South Pit Road. Land Dept stockpile on site.
Sphinx 552-08D	NW-NW 08-55-12	\$3.50 PW Use Only	PW Use Only	5	Y	Gravel, small cobble. Public Works and Land Dept. stockpiles. Blacktop chunks and millings, temp storage for future crushing project.
West Branch 553-29R	SW-SE 29-55-13	\$3.50 LAND & PW Use Only	N	5	N	Land Dept and Public Works use only. Land Dept stockpile of old Class-5 on site. Mixed gravel, site needs test pitting to develop pit plan. Road route needs to be evaluated as pit floor is expanded.
Wet Lake 542-18J	NE-SE 18-54-12	\$3.50 PW Use Only	PW Use Only	6	Y	Land Dept and Public Works use only. Public Works class-five pile and Land Dept stockpiles on site. Public Works Blacktop chunks and millings pile, temp storage for future crushing project.

Public Works Supervisors: Dist. #5 – Gordy Halverson Dist. #6 Gerald VanGuilder

- **Send pit maps to Public Works along with the permit.**



Brimson Zone

Gravel Pits

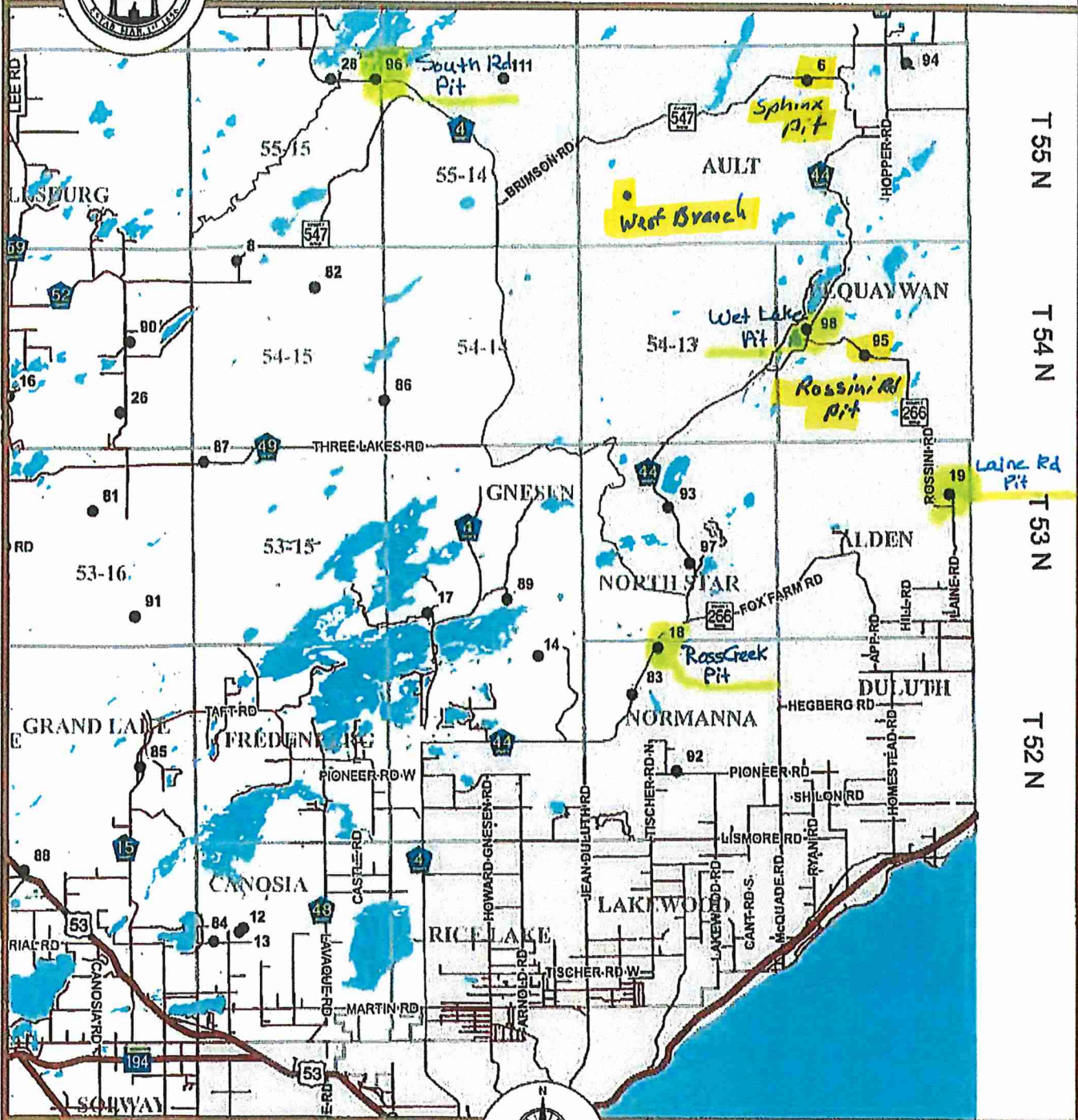

T 55 N
T 54 N
T 53 N
T 52 N

● Land Dept Gravel Pits



© Copyright Saint Louis County
All Rights Reserved

Prepared By: Land Department
Data Resource Section
(218) 725-5000
www.co.st-louis.mn.us

Map Created: 3/4/2008
Location: M/GRAVEL

Notes:

Disclaimer
This is a compilation of records as they appear in the Saint Louis County Office affecting the area shown. This drawing is to be used only for reference purposes and the County is not responsible for any inaccuracies herein contained.

Tracking #: 10.10



St. Louis County MN