

# St. Louis County

## F23-541912

HALKALA RD

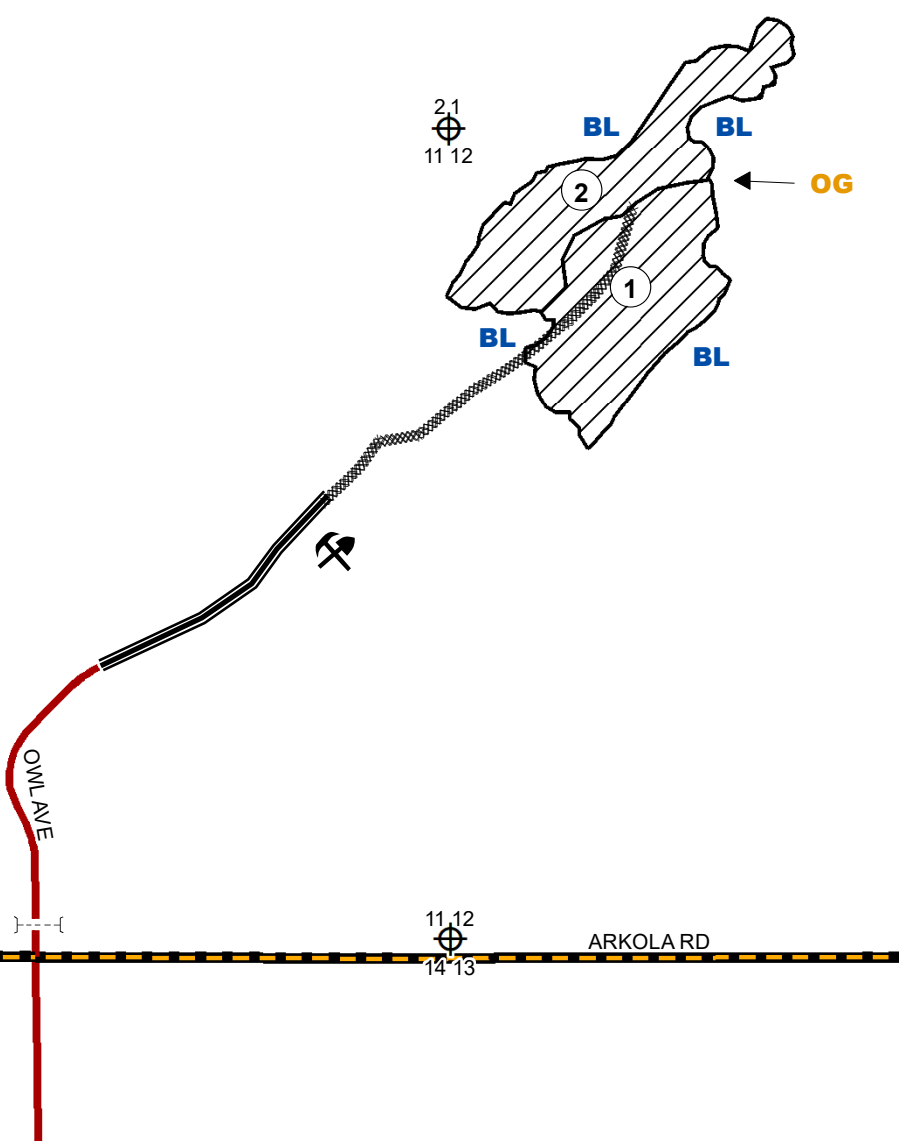

Sale Acres:  
 Block 1: 28.2 ac  
 Block 2: 24.6 ac  





---

 Total: 52.8 acres

Reserve all: Birch and Snags

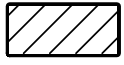
Prepared By: Carlson  
 Map Created: 4/20/2023  
 TRS: 54-19-01,12

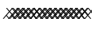
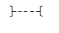
Disclaimer:  
 This is a compilation of records as they appear in the Saint Louis County Offices affecting the area shown. This drawing is to be used only for reference purposes and the County is not responsible for any inaccuracies herein contained.

-  Clearcut
-  Gravel Pit
- BL** Painted Blue Line
- OG** Painted Orange Block Line
-  Forest Management Road
-  Proposed Access Road (minimal upgrade needed)
-  Gate (locked)

